

A

B

C

D

E

F

| REV | DESCRIPTION | DESIGN | DATE |
|-----|-------------|--------|------|
| A   | Release     | -      | -    |
| -   | -           | -      | -    |

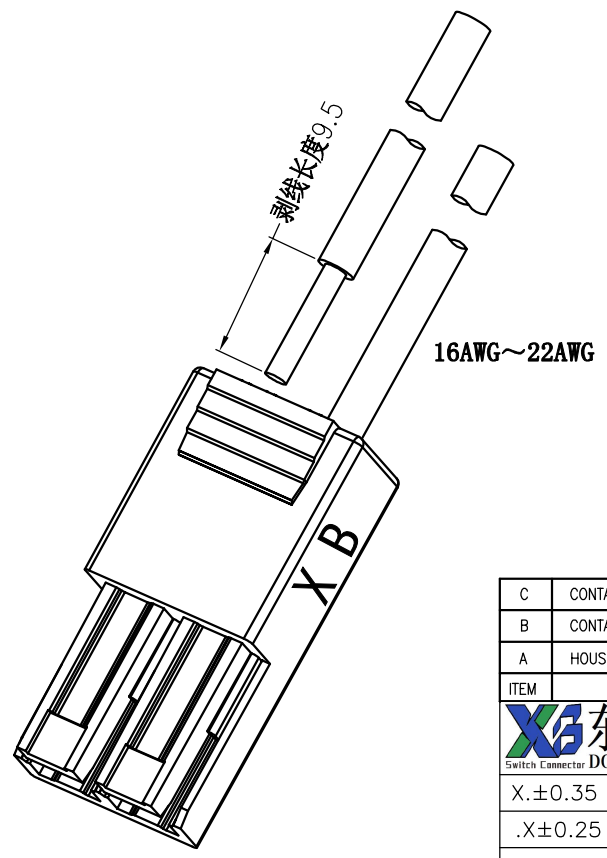
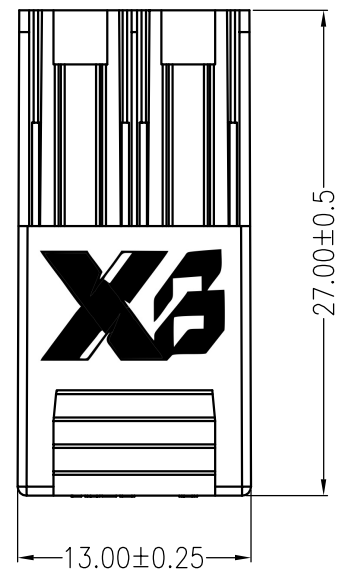
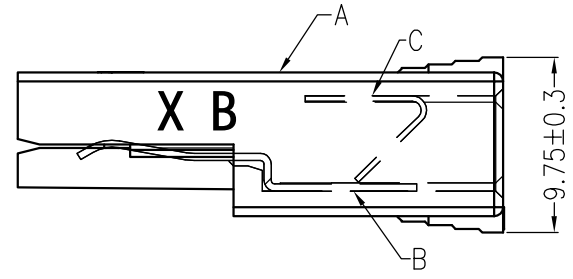
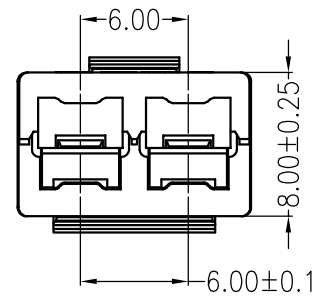

**主要技术参数 Main Specifications**

- 线 数 (Poles): 02
- 接触电阻 (Contact resistance):  $\leq 25m\Omega$
- 绝缘电阻 (Insulation resistance):  $\geq 1000M\Omega$
- 额定电压 (Rated voltage): 600V AC DC
- 额定电流 (Rated current): 3A AC DC
- 耐 电 压 (Withstand Voltage): 2200V AC/minute
- 温度范围 (Temperature Range):  $-40^{\circ}C \sim +105^{\circ}C$

ORDER INFORMATION:

**XB- L046-02-G10A1-P**

|                   |                 |                 |                  |
|-------------------|-----------------|-----------------|------------------|
| PART No.          |                 | PACKAGING:      |                  |
| No. FOR CIRCUITS: | 02              | P=PE            |                  |
| PLASTIC MATERIAL: | G10=PC (orange) | Metal material: | 1=PhosphorBronze |
|                   |                 | PLATING:        | A=Sn             |

| ITEM | COMPONENT | Q'TY  | MATERIAL        | FINISH                 |
|------|-----------|-------|-----------------|------------------------|
| C    | CONTACT   | 2 PCS | Stainless steel | No electroplating      |
| B    | CONTACT   | 2 PCS | PhosphorBronze  | Sn plated              |
| A    | HOUSING   | 1 PCS | PC              | UL 94V-0, COLOR:orange |

**XB 东莞市溪榜电子有限公司**  
Switch Connector DONG GUAN XI BANG ELECTRONICS CO., LTD

TITLE: 6mmPITCH Housing  
PART NO.: L046-02-G10A1-P  
DWG NO.: GCCP-0075  
SCALE: 1 : 1  
SHEET: 1 / 1

|           |      |       |             |
|-----------|------|-------|-------------|
| X.±0.35   | X.±  | USE:  | MANUFACTURE |
| .X±0.25   | .X±  | APPD: | 邵敬和         |
| .XX±0.15  | .XX± | CHKD: | 田峰          |
| --        | --   | DR:   | 蒋建银         |
| UNITS: mm |      |       |             |

A

B

C

D

E

F

1

2

3

4

5

1

2

3

4

5